



## 16.4 Braking resistors

2S/T Class Inverter (200÷230Vac)

SINUS M	0001 2S/T	0002 2S/T	0003 2S/T	0005 2S/T	0007 2S/T	0011 2S/T
Resistor	200Ω 350W*	100Ω 350W	56Ω 350W	56Ω 350W	50Ω 1100W	15Ω 1100W
Code	RE2644200	RE2644100	RE2643560	RE2643560	RE3083500	RE3083150

2S/T Class Inverter (200÷230Vac)

SINUS M	0014 2S/T	0017 4T	0020 4T	0025 4T	0030 4T
Resistor	15Ω 1100W	10Ω 2200W	10Ω 2200W	5Ω 4000W	5Ω 4000W
Code	RE3083150	RE3113100	RE3113100	RE3482500	RE3482500

4T Class Inverter (380÷480Vac)

SINUS M	0001 4T	0002 4T	0003 4T	0005 4T	0007 4T	0011 4T
Resistor	400Ω 350W	400Ω 350W	200Ω 350W	200Ω 350W	100Ω 550W	75Ω 550W
Code	RE2644400	RE2644400	RE2644200	RE2644200	RE3064100	RE3063750

4T Class Inverter (380÷480Vac)

SINUS M	0014 4T	0017 4T	0020 4T	0025 4T	0030 4T
Resistor	50Ω 1100W	33Ω 2200W	33Ω 2200W	20Ω 4000W	20Ω 4000W
Code	RE3083500	RE3113330	RE3113330	RE3483200	RE3483200

Suggested braking resistors are for standard applications where enable duty and continuous braking are lower than the given values. For heavy duty (applications where load is pulled for more time than max. continuous braking, stopping of big flywheels and so on), please contact Elettronica Santerno.

\* The wattage is based on Enable duty (%ED) 5%, Average braking torque of 150% with a continuous braking time of 15 sec.

### 16.4.1 Dimensions

#### Model 350W - IP55

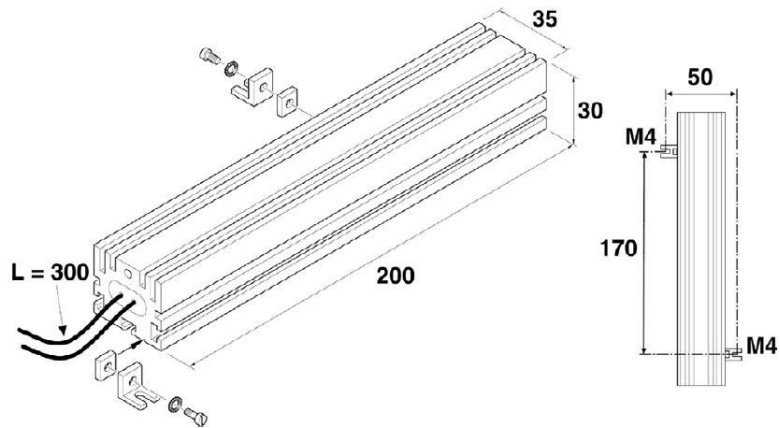

Overall Dimensions, Resistor 350W – IP55

#### Model 550W - IP55

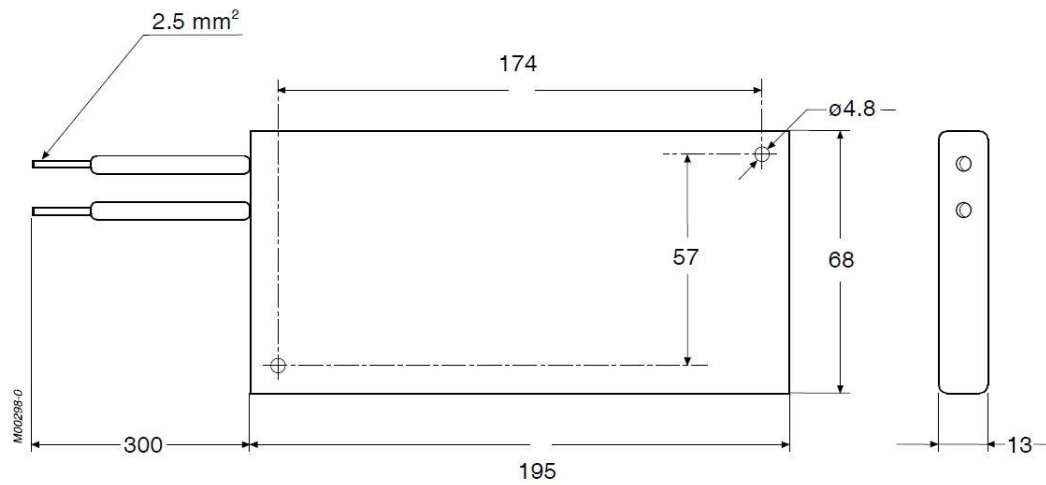

Overall Dimensions, Resistor 550W – IP55

Model 1100W - IP55

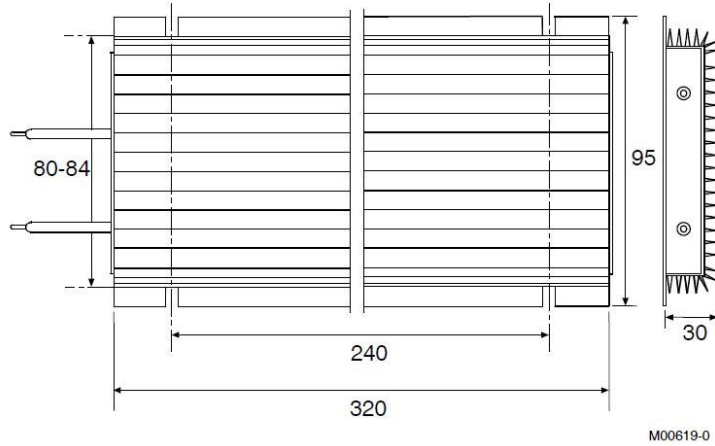

Overall Dimensions, Resistor 1100W – IP55

Model 2200W – IP54

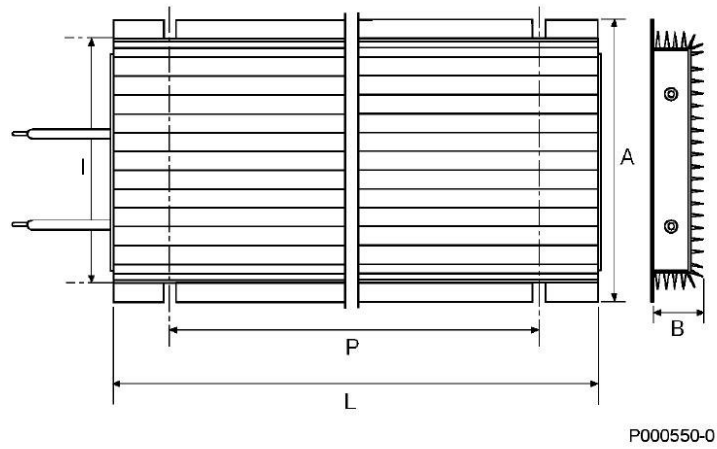

A (mm)	B (mm)	L (mm)	I (mm)	P (mm)
190	67	380	177-182	300

Overall Dimensions, Resistor 2200W – IP54



Model 4000W - IP20

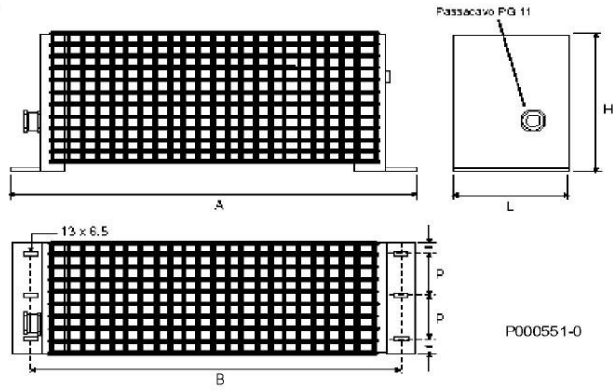

A (mm)	B (mm)	L (mm)	H (mm)	P (mm)
620	600	100	250	40

Overall Dimensions, Resistor 4000W - IP20

### 16.4.2 Braking resistor wiring diagram

Wire the braking resistor to terminals B1 and B2 on the inverter as short as possible.

Power terminal wiring (0.4 ~ 7.5kW)

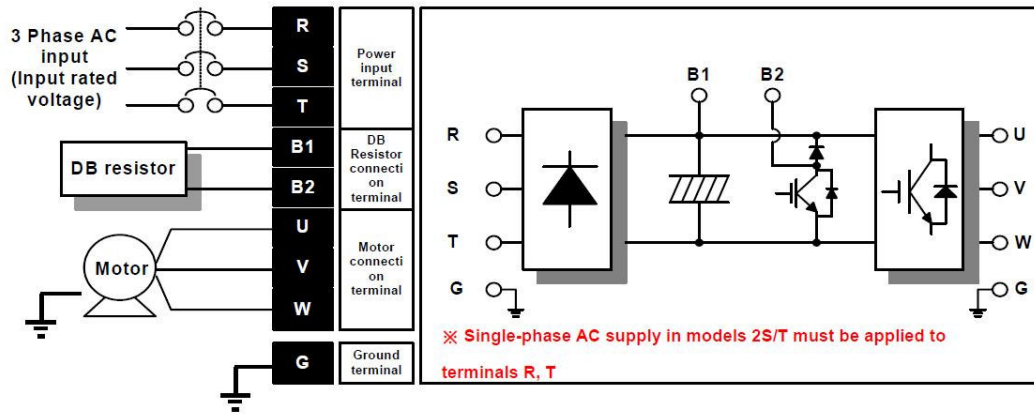

Power terminal wiring (11.0 ~ 22.0kW)

